

## Pressure Vs Voltage

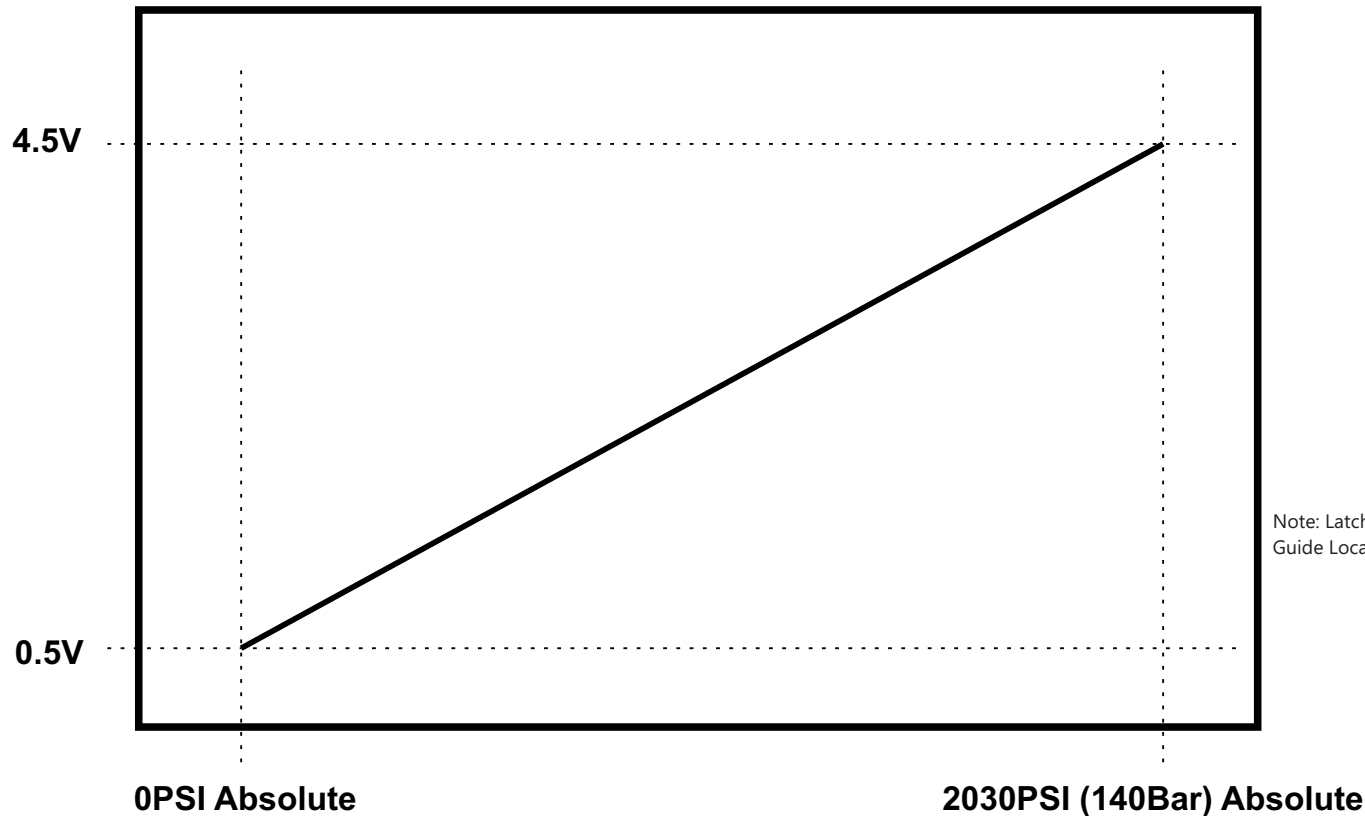

### NOTES:

This is an active sensor. Do not use a pull-up resistor on the signal of this sensor. The output is driven to the correct voltage by the electronics inside the sensor.

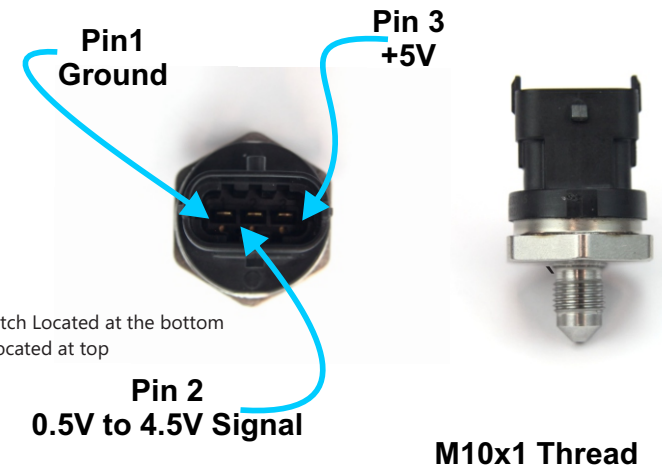

Note: Latch Located at the bottom  
 Guide Located at top

### APPLICATIONS:

This sensor is most often used to monitor Clutch, Brake or Nitrous Pressure.

Mating Connector- : H-MODL2C  
 M10x1 -1/8NPT Adaptor: H-PS150-ADPT